

## Ground floor

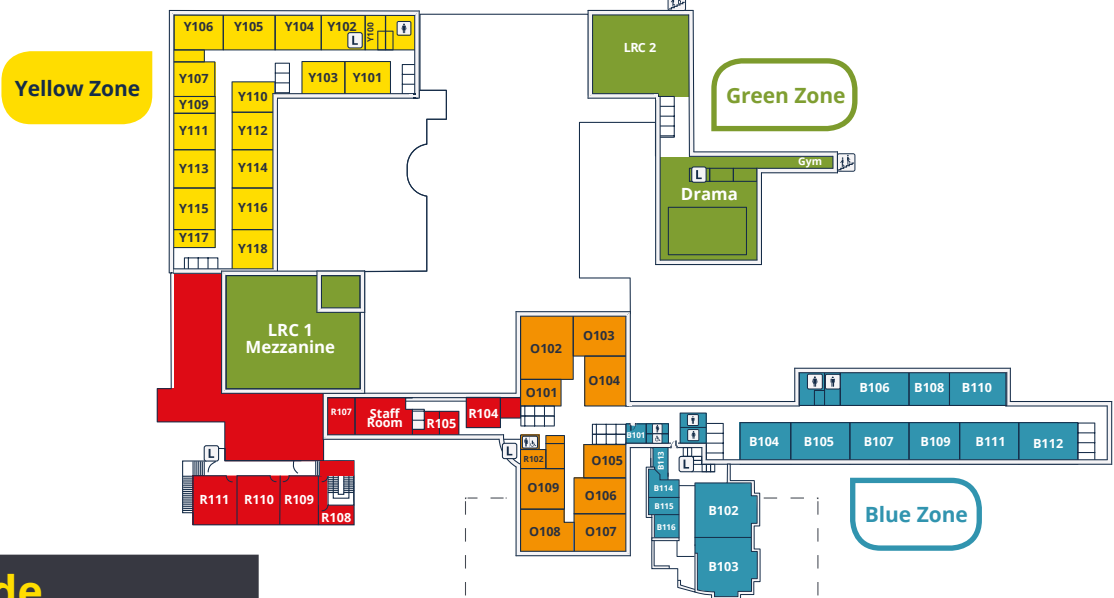



## 1<sup>st</sup> floor



## Room Guide

Esher Sixth Form College is divided into colour zones

Each zone starts with the first letter of its colour, e.g. Y = Yellow zone

- The next digit indicates which floor, e.g.
    - 0 = Ground Floor
    - 1 = First Floor
    - 2 = Second Floor
    - 3 = Third Floor
  - The last 2 digits indicate the room number
  - ALN Centre = Additional Learning Needs Centre
-  Lift
  Fire Exit Stairs  
 Gender Neutral and Accessible WC

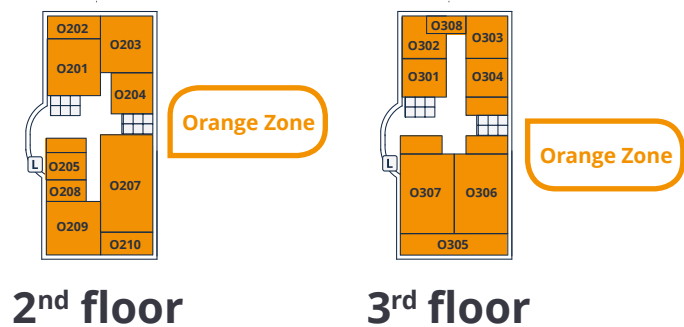

## 2<sup>nd</sup> floor

## 3<sup>rd</sup> floor